

# SW 60 D/W Series

## Shrink Wrapper



- For loose and pre-packed products
- Low film consumption
- Quick film reel change
- Can be directly combined with tray packer VP 450/451

**Meypack**  
**Verpackungssystemtechnik GmbH**

Industriestraße 3  
D-48301 Nottuln-Appelhülsen  
Tel: +49(0) 25 09-9 40  
Fax: +49(0) 25 09-94 81 90  
info@meypack.de  
www.meypack.com

## Meypack SW 60 D/W Series



### Functions



- **Frequency converter product transport drive** for speeds exceeding 25 cycles/min.

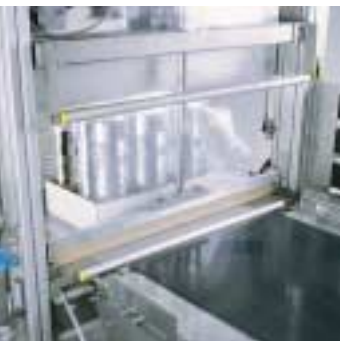

- **Constantly heated sealing beam**, low maintenance, long life and simple to change.



- **High efficiency** flat belt, wire mesh or roller conveyor shrink tunnel.

### Layout possibilities

- SW 60-W for right angle product infeed:
- Top view

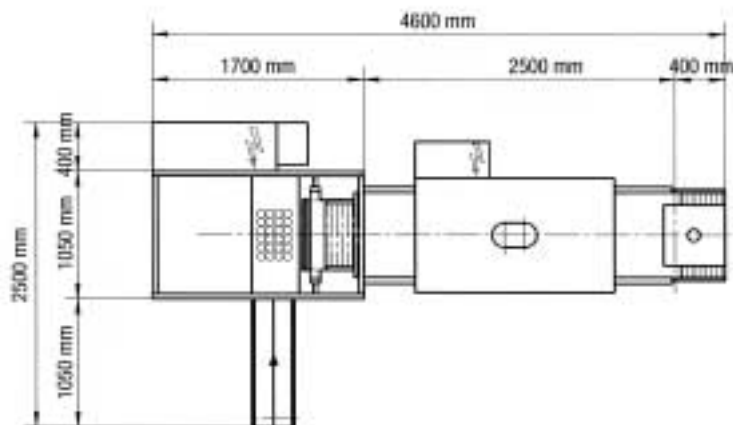

- SW 60-D for direct product infeed:
- Top view

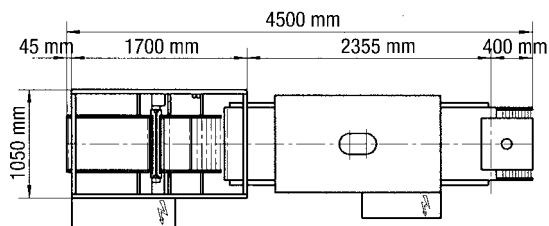

### Pack styles



#### Technical Specifications Model SW 60 D/SW 60 W

**Infeed height:** 850 mm

**Max. film width:**

550 mm

(Sealing beam width: 600 mm)

**Max. film reel diameter:**

350 mm - infeed height 850 mm

300 mm - infeed height 700 mm

**Max. product height:** 350 mm

**Max. product depth:**

300 mm (angular product infeed)

**Speed:**

10-30 cycles/min.

**Connected load:**

approx. 2,5 kW (excl. shrink tunnel)

approx. 24 kW (incl. shrink tunnel)

**Air pressure:** 15 NL/cycle, 6 bar

**SW 60 D:** approx. 600 kg

**SW 60 W:** approx. 650-900 kg

depending on version